

## **Vacuum Filters**



# Vacuum filters

Technical data

FESTO

## Filters ESF

### Function



Note

for suction grippers ESG, between suction cup and suction cup holder

→ Internet: esg

-  - Temperature range  
0 ... +60 °C

-  - Operating pressure  
-0.95 ... +4 bar



General technical data			
Holder size	3	4A	4B
Assembly position	Any		
Type of mounting	In-line installation with threaded connection		
Vacuum connection	M4x0.7	M6x1	
Grade of filtration [µm]	10		
Flow rate <sup>1)</sup> [l/min]	100	260	270

1) At a vacuum pressure of -0.75 bar

Operating and environmental conditions			
Holder size	3	4A	4B
Operating pressure [bar]	-0.95 ... +4		
Ambient temperature [°C]	0 ... +60		
Corrosion resistance class CRC <sup>1)</sup>	1		

1) Corrosion resistance class 1 as per Festo standard 940 070

Components requiring low corrosion resistance Transport and storage protection. Parts that do not have primarily decorative surface requirements, e.g. in internal areas that are not visible or behind covers.

Materials	
Housing	Aluminium, nickel-plated brass
Filters	Polyvinylfluoride
Seals	Nitrile rubber
Material note	Free of copper and PTFE

Weights [g]			
Holder size	3	4A	4B
ESF- ...	9	19	19

### Dimensions and ordering data

Download CAD data → [www.festo.com](http://www.festo.com)

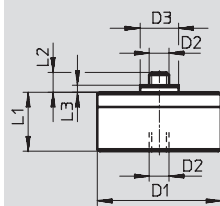

D1 Ø	D2	D3 Ø	L1	L2	L3	Part No.	Type
25	M4x0.7	7.8	10.5	4.5	3.1	191 202	ESF-3
25	M6x1	8.8	10.5	5.5	3.9	191 203	ESF-4A
40	M6x1	8.8	14	5.5	3.9	191 204	ESF-4B

# Vacuum filters

Technical data

FESTO

## Vacuum filters VAF-PK

### Function

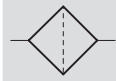

Note

The vacuum suction filter may only be used in open vacuum systems.

-  - Temperature range  
0 ... +40 °C

-  - Operating pressure  
-0.9 ... 0 bar

The vacuum suction filter serves for filtering dirt in the direction of suction.  
It is inserted in the tubing as an inline filter.



### General technical data

Size	PK-3	PK-4	PK-6
Operating medium	Atmospheric air		
Mounting position	Any		
Type of mounting	In-line installation		
Pneumatic connection	PK-3 with locknut	PK-4 with locknut	PK-6 with locknut
Grade of filtration [µm]	50		
Vacuum filter flow [l/min]	50.8	70	210
Nominal size [mm]	2	3	4.6
Ejector pulse possibility [bar]	≤8		

1) At vacuum pressure = -0.75 bar

### Operating and environmental conditions

Size	PK-3	PK-4	PK-6
Operating pressure [bar]	-0.95 ... 0		
Ambient temperature [°C]	0 ... +40		

### Materials

Housing	Polyamide
Filter	Mesh / Polyamide
Union nut	Polyacetate
Note on materials	RoHS-conform

### Weights [g]

Size	PK-3	PK-4	PK-6
VAF- ...	4	6	10

# Vacuum filters

Technical data

**FESTO**

## Dimensions

Download CAD data → [www.festo.com](http://www.festo.com)

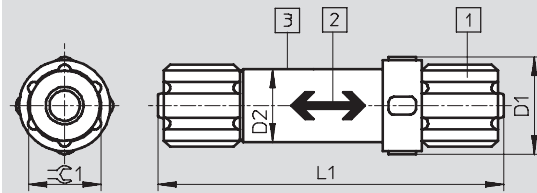

- 1 Quick connectors for plastic tubing
- 2 Flow direction indicated with arrow
- 3 Degree of contamination visible through the transparent housing

Type	D1 Ø	D2 Ø	L1	≅ 1
VAF-PK-3	16	12	50.8	8
VAF-PK-4	16	12	57	12
VAF-PK-6	24	19	64	14

## Ordering data

Pneumatic connection	Part No.	Type
PK-3	535 883	VAF-PK-3
PK-4	15 889	VAF-PK-4
PK-6	160 239	VAF-PK-6

# Vacuum filters

Technical data

FESTO

## Vacuum filters VAF-DB

### Function

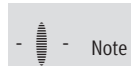
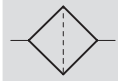

Note

The vacuum filter must only be used in open vacuum systems.

- - Temperature range  
-5 ... +50 °C

- - Operating pressure  
-0.95 ... 0 bar

The vacuum filter is used to remove particles in the direction of suction. The filter cartridge is located in a transparent bowl in order to identify the degree of contamination of the filter cartridge. The filter cartridge can be replaced.



### General technical data

Pneumatic connection	G $\frac{1}{4}$	G $\frac{3}{8}$	G $\frac{1}{2}$
Operating medium	Atmospheric air		
Mounting position	Vertical		
Type of mounting	In-line installation With wall/surface bracket		
Vacuum port	G $\frac{1}{4}$	G $\frac{3}{8}$	G $\frac{1}{2}$
Grade of filtration [μm]	80		
Ejector pulse suitability [bar]	≤7		
Max. tightening torque [Nm]	8.7	15.3	20.5

1) At vacuum = -0.75 bar

### Operating and environmental conditions

Pneumatic connection	G $\frac{1}{4}$	G $\frac{3}{8}$	G $\frac{1}{2}$
Operating pressure [bar]	-0.95 ... 0		
Ambient temperature [°C]	-5 ... +50		

### Materials

Housing	Reinforced polypropylene		
Bowl	Polyamide		
Filter	Polyethylene		
Seals	Nitrile rubber		
Note on materials	RoHS-compliant Contains PWIS (paint-wetting impairment substances)		

### Weights [g]

Pneumatic connection	G $\frac{1}{4}$	G $\frac{3}{8}$	G $\frac{1}{2}$
VAF-DB- ...	71	156	162

# Vacuum filters

Technical data



Standard flow rate  $q_n$  as a function of differential pressure  $\Delta p_{1-2}$

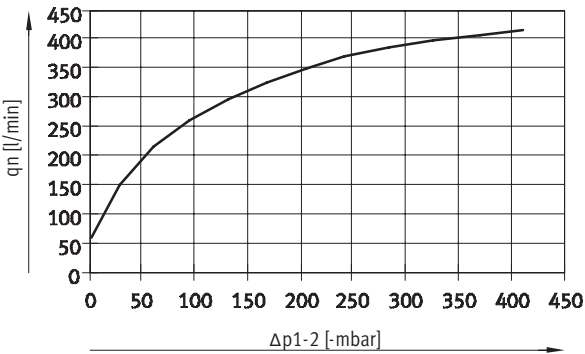

— VAF-DB- 1/4

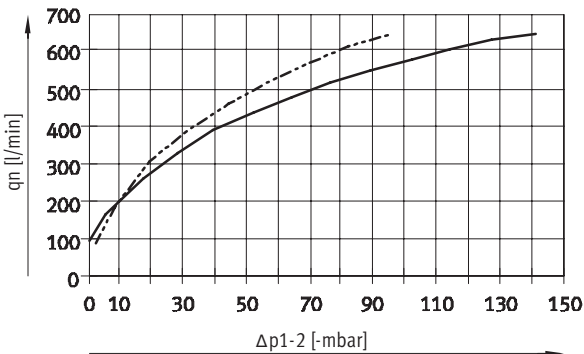

— VAF-DB- 3/8  
 - - - VAF-DB- 1/2

Dimensions and ordering data Download CAD data → [www.festo.com](http://www.festo.com)

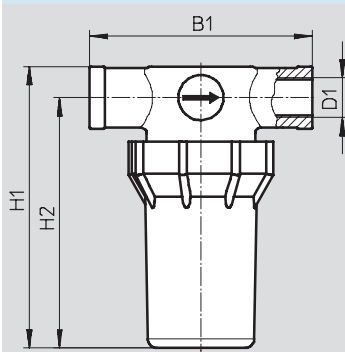

Connection D1	B1	H1	H2	Part No.	Type
1/4	75	94.5	84.5	547 261	VAF-DB- 1/4
3/8	90.5	125	113	553 140	VAF-DB- 3/8
1/2	90.5	129	115	553 141	VAF-DB- 1/2

## Vacuum filters

Accessories

FESTO

### Mounting bracket VAF-DB-HR for vacuum filter VAF-DB

Type of mounting: Threaded  
Max. tightening torque: 0.63 Nm

Material:  
High-alloy stainless steel

Note on materials:  
RoHS-compliant  
Contains PWIS (paint-wetting  
impairment substances)

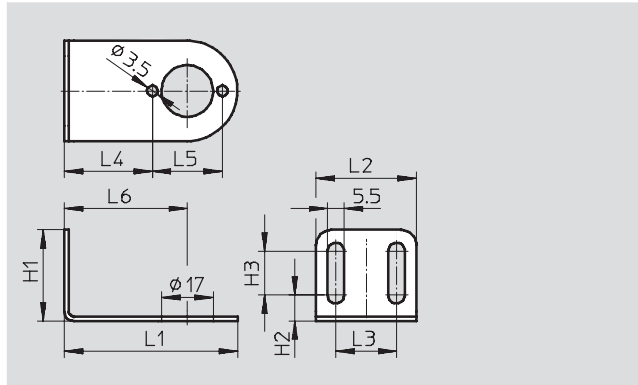

Dimensions and ordering data											
L1	L2	L3	L4	L5	L6	H1	H2	H3	CRC <sup>1)</sup>	Weight [g]	Part No. Type
57	33	20	29	23	40.5	30	8.5	14.5	2	27	553 144 VAF-DB-HR-1/8-1/4
80	53	35	37	33	53.5	50	13.5	24.5	2	92	553 145 VAF-DB-HR-3/8-1/2

- 1) Corrosion resistance class 2 according to Festo standard 940 070  
Components subject to moderate corrosion stress. Externally visible parts with primarily decorative surface requirements which are in direct contact with a normal industrial environment or media such as coolants or lubricating agents.

### Filter cartridge VAF-DB-P for vacuum filter VAF-DB

Type of mounting: Plug-in

Material: Polyethylene

Note on material:  
RoHS-compliant  
Contains PWIS (paint-wetting  
impairment substances)



Ordering data		
	Part No.	Type
Filter cartridge	553 142	VAF-DB-P-1/8-1/4
	553 143	VAF-DB-P-3/8-1/2



# Product Range and Company Overview

## A Complete Suite of Automation Services

Our experienced engineers provide complete support at every stage of your development process, including: conceptualization, analysis, engineering, design, assembly, documentation, validation, and production.



**Custom Automation Components**  
Complete custom engineered solutions



**Custom Control Cabinets**  
Comprehensive engineering support  
and on-site services



**Complete Systems**  
Shipment, stocking and storage services

## The Broadest Range of Automation Components

With a comprehensive line of more than 30,000 automation components, Festo is capable of solving the most complex automation requirements.



**Electromechanical**  
Electromechanical actuators, motors,  
controllers & drives



**Pneumatics**  
Pneumatic linear and rotary actuators,  
valves, and air supply



**PLCs and I/O Devices**  
PLC's, operator interfaces, sensors  
and I/O devices

## Supporting Advanced Automation... As No One Else Can!

Festo is a leading global manufacturer of pneumatic and electromechanical systems, components and controls for industrial automation, with more than 12,000 employees in 56 national headquarters serving more than 180 countries. For more than 80 years, Festo has continuously elevated the state of manufacturing with innovations and optimized motion control solutions that deliver higher performing, more profitable automated manufacturing and processing equipment. Our dedication to the advancement of automation extends beyond technology to the education and development of current and future automation and robotics designers with simulation tools, teaching programs, and on-site services.

## Quality Assurance, ISO 9001 and ISO 14001 Certifications

Festo Corporation is committed to supply all Festo products and services that will meet or exceed our customers' requirements in product quality, delivery, customer service and satisfaction.

To meet this commitment, we strive to ensure a consistent, integrated, and systematic approach to management that will meet or exceed the requirements of the ISO 9001 standard for Quality Management and the ISO 14001 standard for Environmental Management.



© Copyright 2008, Festo Corporation. While every effort is made to ensure that all dimensions and specifications are correct, Festo cannot guarantee that publications are completely free of any error, in particular typing or printing errors. Accordingly, Festo cannot be held responsible for the same. For Liability and Warranty conditions, refer to our "Terms and Conditions of Sale", available from your local Festo office. All rights reserved. No part of this publication may be reproduced, distributed, or transmitted in any form or by any means, electronic, mechanical, photocopying or otherwise, without the prior written permission of Festo. All technical data subject to change according to technical update.



Printed on recycled paper at New Horizon Graphic, Inc., FSC certified as an environmentally friendly printing plant.

# Festo North America

## United States

### Customer Resource Center

502 Earth City Expy., Suite 125  
Earth City, MO 63045

For ordering assistance, or to find  
your nearest Festo Distributor,

**Call:** 1.800.99.FESTO

**Fax:** 1.800.96.FESTO

**Email:** [customer.service@us.festo.com](mailto:customer.service@us.festo.com)

For technical support,

**Call:** 1.866.GO.FESTO

**Fax:** 1.800.96.FESTO

**Email:** [product.support@us.festo.com](mailto:product.support@us.festo.com)

### Headquarters

Festo Corporation  
395 Moreland Road  
P.O. Box 18023  
Hauppauge, NY 11788  
[www.festo.com/us](http://www.festo.com/us)

## Sales Offices

### Appleton

N. 922 Tower View Drive, Suite N  
Greenville, WI 54942

### Boston

120 Presidential Way, Suite 330  
Woburn, MA 01801

### Chicago

1441 East Business Center Drive  
Mt. Prospect, IL 60056

### Dallas

1825 Lakeway Drive, Suite 600  
Lewisville, TX 75057

### Detroit - Automotive Engineering Center

2601 Cambridge Court, Suite 320  
Auburn Hills, MI 48326

### New York

395 Moreland Road  
Hauppauge, NY 11788

### Silicon Valley

4935 Southfront Road, Suite F  
Livermore, CA 94550

## Design and Manufacturing Operations



**East:** 395 Moreland Road, Hauppauge, NY 11788



**Central:** 1441 East Business Center Drive, Mt. Prospect, IL 60056



**West:** 4935 Southfront Road, Suite F, Livermore, CA 94550

## Mexico

### Headquarters

Festo Pneumatic, S.A.  
Av. Ceylán 3, Col. Tequesquahuac  
54020 Tlalnepantla, Edo. de México  
Call: 011 52 [55] 53 21 66 00  
Fax: 011 52 [55] 53 21 66 65  
Email: [festo.mexico@mx.festo.com](mailto:festo.mexico@mx.festo.com)  
[www.festo.com/mx](http://www.festo.com/mx)



## Canada

### Headquarters

Festo Inc.  
5300 Explorer Drive  
Mississauga, Ontario L4W 5G4  
Call: 1.905.624.9000  
Fax: 1.905.624.9001  
Email: [info.ca@ca.festo.com](mailto:info.ca@ca.festo.com)  
[www.festo.com/ca](http://www.festo.com/ca)



## Festo Worldwide

Argentina Australia Austria Belarus Belgium Brazil Bulgaria Canada Chile China Colombia Croatia Czech Republic Denmark  
Estonia Finland France Germany Great Britain Greece Hong Kong Hungary India Indonesia Iran Ireland Israel Italy Japan  
Latvia Lithuania Malaysia Mexico Netherlands New Zealand Norway Peru Philippines Poland Romania Russia Serbia Singapore  
Slovakia Slovenia South Africa South Korea Spain Sweden Switzerland Taiwan Thailand Turkey Ukraine United States Venezuela

[www.festo.com](http://www.festo.com)