

E40159

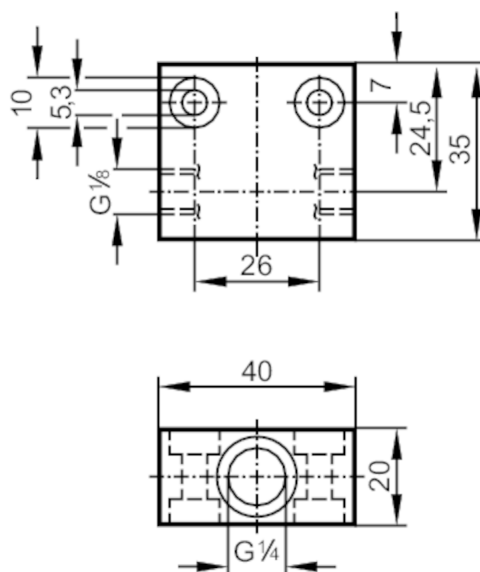

Process adapter for small volumetric flow quantities

FLOW ADAPT SF PTFE



Application

Design	for flow sensors with ceramic probe G $\frac{1}{4}$
Installation	via internal G1/8A male thread, any mounting position
Medium temperature [°C]	0...80
Pressure rating [bar]	30

Measuring/setting range

Flow range [ml/min]	2...50
---------------------	--------

Tests / approvals

Pressure equipment directive	A possible classification to PED depends on the application and has to be carried out by the user / operator.
Pressure Equipment Directive EAC	The adapter is intended for use in devices, machines and installations that do not fall under the categories of the technical rule TR CU 032/2013.
Safety instructions	The compatibility between medium and product material has to be checked in all applications.

Mechanical data

Weight [g]	48
Material	PTFE
Sensor connection	G $\frac{1}{4}$
Process connection	G $\frac{1}{8}$

Remarks

Pack quantity	1 pcs.
---------------	--------