Emergency stop rope pull switches Preventa XY2C

Catalogue



Simply easy!™

Emergency stop rope pull switches Preventa XY2C

Emergency stop rope pull switches Preventa XY2CJ, XY2CH and XY2CE

- **General**
 - Presentation page 2
 - Installation page 2
 - Main features page 3
 - Standards page 3
 - Adjustment values with end spring page 4
- **Characteristics** page 5
- **References**
 - Latching emergency stops pages 6 and 7
 - Separate components page 8
 - Kits and mounting accessories page 9
 - Replacement parts page 10
- **Dimensions** page 11
- **Product reference index** page 12

Safety detection solutions

Emergency stop rope pull switches

Preventa XY2C

Presentation

Emergency stop rope pull switches

Emergency stop rope pull switches are designed to:

- avert hazards (dangerous phenomena) at the earliest possible moment, or to reduce risks which could cause injury to persons or damage either to machines or work in progress
- be tripped by a single human action when a normal emergency stop function is not available
- trip in the event of the rope pull breaking

Emergency stop rope pull switches are essential in premises and on machines that are potentially dangerous when operating. The operator must be able to trigger the stop instruction at any point within their working area.

Application examples: woodworking machines, shears, conveyor systems, printing machines, textile machines, rolling mills, test laboratories, paint shops, surface treatment works.

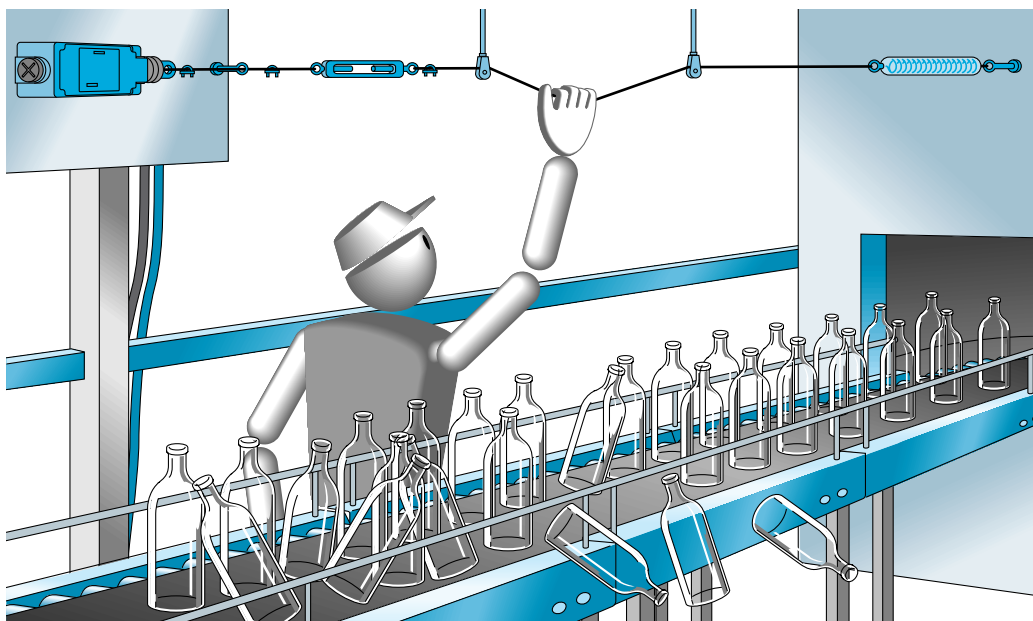

Installation

Typical installation

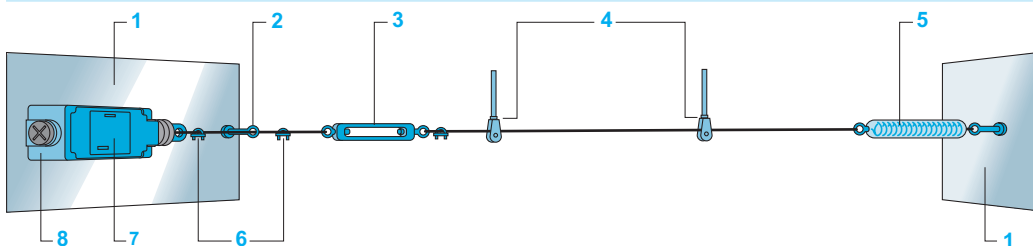

- | | | |
|-----------------------|-------------------------------|---------------------|
| 1 Fixing support | 4 Pulley supports and pulleys | 7 Switch adjustment |
| 2 First cable support | 5 End spring | 8 Emergency stop |
| 3 Turnbuckle | 6 Cable grips | |

Notes regarding installation

- All XY2CJ, XY2CH and XY2CE emergency stop rope pull switches can be fitted with trip indicators (mechanical indicators for XY2CJ, pilot lights for XY2CH and XY2CE).
- Cable tension adjustment can be performed using:
 - a turnbuckle to be ordered separately (see page 8)
 - a tensioner integrated in XY2CH emergency stop rope pull switches and optional for XY2CJ emergency stop rope pull switches
- This adjustment is simplified by:
 - a cable tension indicator that is available on all XY2CJ, XY2CH and XY2CE models. XY2CE emergency stop rope pull switches incorporate a cable tension indicator, visible with the cover open. There is also an optional version with a window for viewing the cable tension, for adjustment whilst the cover is closed.
- The use of an end spring is mandatory for conveyor system applications to ensure operation of the emergency stop in the event of the cable being pulled towards the switch.
- It is essential that pulleys be used with cables that deviate from a straight run.

Safety detection solutions

Emergency stop rope pull switches

Preventa XY2C

Main features

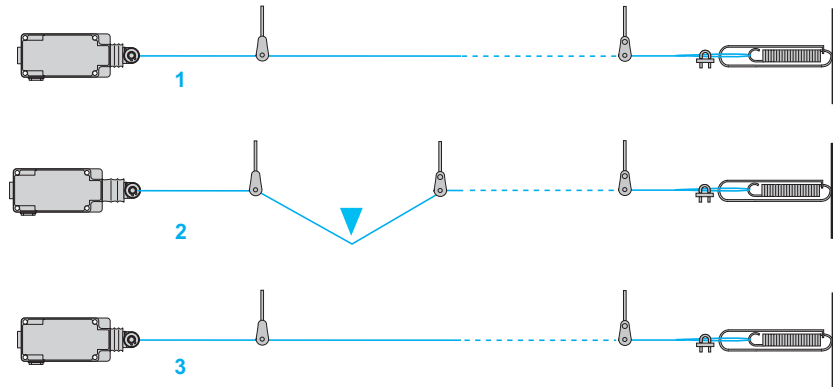

| | | |
|---|----------|--|
| Positive operation: running condition | 1 | The switches incorporate positive opening operation contacts, the tripping of the switch being made with positive action. |
| Latching: stop instruction given (tripped) | 2 | The switch latches in the tripped position (NC safety contact(s) open). The function of the NO contact is purely for signalling. |
| Resetting: stop condition (awaiting reset/restart) | 3 | The switches incorporate a reset button, which re-closes the safety contact. Restarting of the machine must only be achieved by manual operation of a control device within the machine start circuit, remote to the emergency stop. |

Rope pull expansion and contraction: d

Temperature variations encountered on site are mainly responsible for these variations in length.

To enable instant verification that the rope pull is at its correct tension (and make any necessary adjustments), XY2CH and XY2CE emergency stop rope pull switches incorporate a cable tension indicator. XY2CE emergency stop rope pull switches incorporate a cable tension indicator, visible with the cover open. To enable instant verification that the rope pull is at its correct tension (and make any necessary adjustments), they are also available with a window for viewing the cable tension.

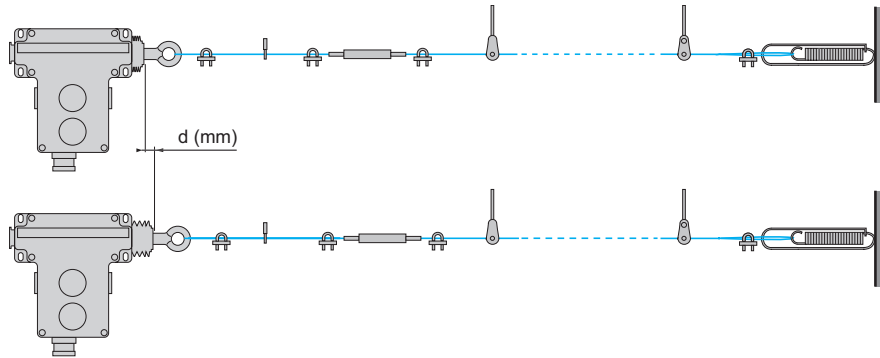

Standards

The XY2CJ, XY2CH and XY2CE switches meet all the requirements of the harmonised European standard **EN/ISO 13850**, relating to "Emergency stop devices". The switches are **CE** marked and supplied with an EC declaration of conformity.

Cable diameter

In order to achieve the maximum cable length, according to ambient temperature variation, we recommend use of:

- galvanised cables with red sheath, diameter 3.2 mm for XY2CJ and XY2CH ranges
- galvanised cables with red sheath, diameter 5 mm for XY2CE range (see page 8)

Safety detection solutions

Emergency stop rope pull switches

Preventa XY2C

Adjustment values (with end spring)

For Preventa XY2CE emergency stop rope pull switches, the adjustment values depend on the positions of the cam located inside the switch. The adjustment is made by rotating the cam after the switch has been installed. Each notched cam position is referenced by the letters A to F and the selected letter is visible through a viewing port.

The use of an end spring is strongly advised. You can see the references in the table below regarding each type:

| Type | Cam position | Maximum cable length | End spring |
|-------------------|------------------|----------------------|------------|
| XY2CJS | – | 20 m | XY2CZ703 |
| XY2CJR and XY2CJL | – | 30 m | XY2CZ703 |
| XY2CH | – | 30 m | XY2CZ703 |
| XY2CE | A, B, C, D, E, F | 70 m | XY2CZ702 |

XY2CJ

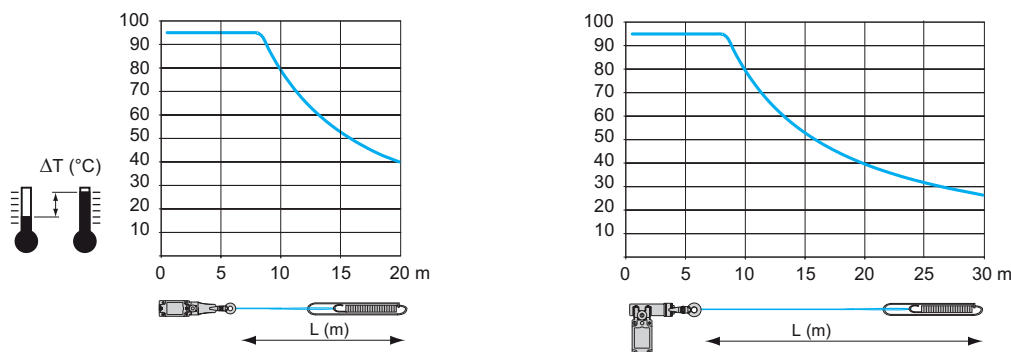

With the graphs above, if we consider an ambient temperature variation of 25°C, for example from 0°C to +25°C, the table gives us a maximum cable length of 20 metres for XY2CJS and 30 metres for XY2CJR and XY2CJL.

XY2CH

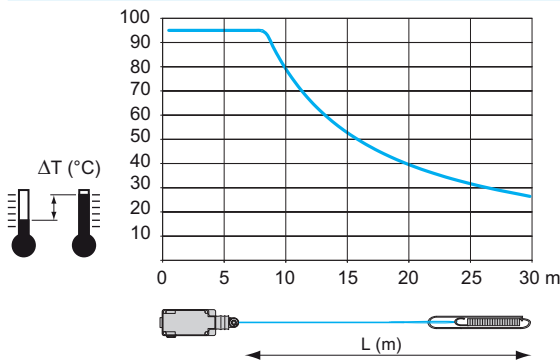

With the graph above, if we consider an ambient temperature variation of 25°C, for example from 0°C to +25°C, the table gives us a maximum cable length of 30 metres.

XY2CE

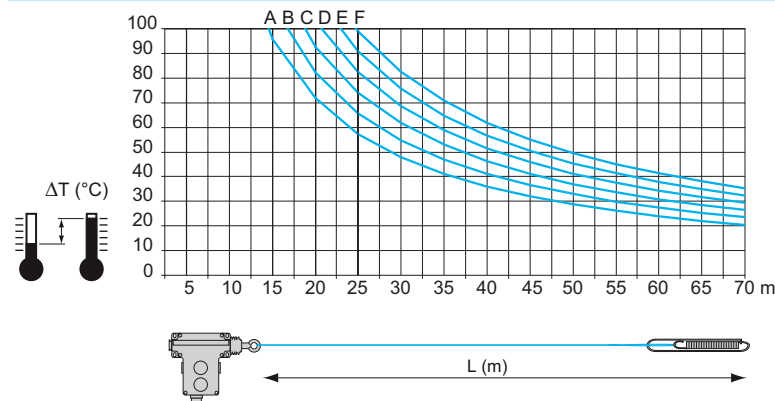

With the graph above, if we consider an ambient temperature variation of 35°C, for example from 10°C to +25°C, the table gives us a maximum cable length of:

- 40 metres, with cam A adjustments
- 70 metres, with cam F adjustments

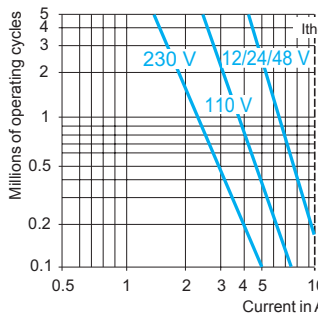
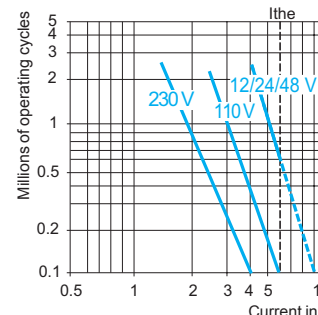
| Environment | | | | | | | | | | |
|--|-----------------------|--|-----------|-----|----|-----|------|----|---|---|
| Conformity to standards | Products | XY2CJ, XY2CH, XY2CE: EN/IEC 60947-5-5, EN/ISO 13850, UL 508 and CSA C 22-2 no. 14 | | | | | | | | |
| | Machine assemblies | XY2CJ, XY2CH, XY2CE: EN/IEC 60204-1, Machinery directive: 2006/42/EC, Work equipment directive: 2009/104/EC | | | | | | | | |
| Product certifications | | XY2CJ: UL (NISD) - CSA, CCC. XY2CH, XY2CE: UL (NISD) - CSA (with suffix H7), CCC (1) | | | | | | | | |
| Maximum safety level (2) | | PL e, category 4 conforming to EN/ISO 13849-1 and SIL CL3 conforming to EN/IEC 62061 | | | | | | | | |
| Reliability data B _{10d} | | XY2CJ: 500,000. XY2CH: 4,000,000. XY2CE: 50,000 (values given for a service life of 20 years but may be limited by contact and mechanical wear) | | | | | | | | |
| Protective treatment | | Standard version: "TC". Special version: "TH" | | | | | | | | |
| Ambient air temperature | | For operation: - 25... + 70°C. For storage: - 40... + 70°C | | | | | | | | |
| Vibration resistance | | XY2CJ, XY2CH: 10 gn (10...150 Hz) XY2CE: 10 gn (10...300 Hz) conforming to EN/IEC 60068-2-6 | | | | | | | | |
| Shock resistance | | XY2CJ, XY2CH, XY2CE: 50 gn (duration 11 ms) conforming to EN/IEC 60068-2-27 | | | | | | | | |
| Electric shock protection | | Class I conforming to IEC 61140 | | | | | | | | |
| Degree of protection | | XY2CJ: IP 66 and IP 67 conforming to IEC 60529. XY2CH, XY2CE: IP 65 conforming to IEC 60529 (IP 66 for XY2CE●A1●● , XY2CE●A2●● and XY2CE●A3●●) | | | | | | | | |
| Materials | | XY2CJS: Zamak body, polyamide head, zinc-plated steel cover XY2CJL, XY2CJR: Zamak body and head, zinc-plated steel cover XY2CH, XY2CE: Zamak body, stainless steel cover | | | | | | | | |
| Mechanical life (no. of operating cycles) | | XY2CJ: 100,000. XY2CH: 800,000. XY2CE: 10,000 | | | | | | | | |
| Length of protected zone (rope pull) | | XY2CJS: ≤ 20 m. XY2CJR and XY2CJL: ≤ 30 m. XY2CH: ≤ 30 m. XY2CE: ≤ 70 m | | | | | | | | |
| Distance between cable supports | | 5 m | | | | | | | | |
| Cable entries | | XY2CJ, XY2CH: tapped entries for Pg 13.5, ISO M20 cable gland or 1/2" NPT. XY2CE: plain holes for Pg 13.5, ISO M20 cable gland or 1/2" NPT See dimensions on page 11 | | | | | | | | |
| Contact block characteristics | | | | | | | | | | |
| Rated operational characteristics | 2-pole contact | XY2CJ, XY2CH, XY2CE: AC-15: A300 or Ue = 240 V, Ie = 3 A DC-13: Q300 or Ue = 250 V, Ie = 0.27 A, conforming to EN/IEC 60947-5-1 Appendix A | | | | | | | | |
| | 3-pole contact | XY2CJ, XY2CH: AC-15: B300 or Ue = 240 V, Ie = 1.5 A DC-13: R300 or Ue = 250 V, Ie = 0.1 A, conforming to EN/IEC 60947-5-1 Appendix A | | | | | | | | |
| Nominal thermal current | 2-pole contact | 10 A | | | | | | | | |
| | 3-pole contact | 6 A | | | | | | | | |
| Rated insulation voltage | 2-pole contact | XY2CJ, XY2CH, XY2CE: Ui = 500 V degree of pollution 3 conforming to EN/IEC 60947-1, Ui = 300 V conforming to UL 508, CSA C22-2 no. 14 | | | | | | | | |
| | 3-pole contact | XY2CJ, XY2CH: Ui = 400 V degree of pollution 3 conforming to EN/IEC 60947-1, Ui = 300 V conforming to UL 508, CSA C22-2 no. 14 | | | | | | | | |
| Rated impulse withstand voltage | 2-pole contact | XY2CJ, XY2CH, XY2CE: Uimp = 6 kV conforming to EN/IEC 60947-1 | | | | | | | | |
| | 3-pole contact | XY2CJ, XY2CH: Uimp = 4 kV conforming to EN/IEC 60947-1 | | | | | | | | |
| Positive operation | | NC contact with positive opening operation conforming to EN/IEC 60947-5-1 Section 3 | | | | | | | | |
| Resistance across terminals | | ≤ 25 mΩ conforming to NF C 93-050 method A or EN/IEC 60255-7 category 3 | | | | | | | | |
| Terminal referencing | | Conforming to CENELEC EN 50013 | | | | | | | | |
| Short-circuit protection | 2-pole contact | XY2CJ, XY2CH, XY2CE: 10 A cartridge fuse type gG (gl) conforming to EN/IEC 60269 | | | | | | | | |
| | 3-pole contact | XY2CJ, XY2CH: 6 A cartridge fuse type gG (gl) conforming to EN/IEC 60269 | | | | | | | | |
| Rated operational power (Electrical durability) | | XY2CJ, XY2CH, XY2CE Conforming to EN/IEC 60947-5-1 Appendix C. Utilisation categories AC-15 and DC-13 Frequency: 3600 operating cycles/hour. Load factor: 0.5 | | | | | | | | |
| AC supply ~ 50/60 Hz mm Inductive circuit | 2-pole contact |  | | | | | | | | |
| | 3-pole contact |  | | | | | | | | |
| DC supply --- Power broken in W for 1 million operating cycles. mm Inductive circuit | | <table border="1"> <thead> <tr> <th>Voltage V</th> <th>24</th> <th>48</th> <th>120</th> </tr> </thead> <tbody> <tr> <td>mm W</td> <td>13</td> <td>9</td> <td>7</td> </tr> </tbody> </table> | Voltage V | 24 | 48 | 120 | mm W | 13 | 9 | 7 |
| | Voltage V | 24 | 48 | 120 | | | | | | |
| mm W | 13 | 9 | 7 | | | | | | | |
| | | <table border="1"> <thead> <tr> <th>Voltage V</th> <th>24</th> <th>48</th> <th>120</th> </tr> </thead> <tbody> <tr> <td>mm W</td> <td>4</td> <td>3</td> <td>2</td> </tr> </tbody> </table> | Voltage V | 24 | 48 | 120 | mm W | 4 | 3 | 2 |
| Voltage V | 24 | 48 | 120 | | | | | | | |
| mm W | 4 | 3 | 2 | | | | | | | |
| Contact connection | | Screw clamp terminals 2 contacts: clamping capacity, min. 1 x 0.5 mm ² /AWG 20, max. 2 x 1.5 mm ² /AWG 16. 3 contacts: clamping capacity, min. 1 x 0.34 mm ² /AWG 22, max. 1 x 1 mm ² /AWG 18 or 2 x 0.75 mm ² /AWG 20. Minimum tightening torque: 0.8 N.m/7.1 lb-in. Maximum tightening torque: 1.2 N.m/10.6 lb-in. | | | | | | | | |

(1) Only products XY2CH without pilot light are CCC and UL-CSA approved.
(2) Using an appropriate and correctly connected control system.

Safety detection solutions

Emergency stop rope pull switches

Preventa XY2C

Latching emergency stops

Pg 13.5, M20 and 1/2" NPT. Cable and end spring to be ordered separately (1)

Without pilot light

| Cable length | Colours and materials | Reset | Supply voltage | Contact type | Cable anchor point | Reference | Weight kg | |
|--------------|---|----------------|----------------|--------------|------------------------|--------------------|-------------------------|-------|
| ≤ 20 m | Polyamide head. Zamak red RAL 3000 body. Treated steel cover. | By pull button | – | 1 1 | NC + NO slow break | RH side or LH side | XY2CJS15 (2) | 0.455 |
| | | | | 2 – | NC + NC slow break | RH side or LH side | XY2CJS17 (2) | 0.455 |
| | | | | 2 1 | 2 NC + 1 NO slow break | RH side or LH side | XY2CJS19 (2) (3) | 0.455 |
| ≤ 30 m | Zamak Red RAL 3000 head and body. Treated steel cover. | By pull button | – | 1 1 | NC + NO slow break | RH side | XY2CJR15 (2) | 0.669 |
| | | | | 2 – | NC + NC slow break | RH side | XY2CJR17 (2) | 0.669 |
| | | | | 2 1 | 2 NC + 1 NO slow break | RH side | XY2CJR19 (2) (3) | 0.669 |
| ≤ 30 m | Zamak Red RAL 3000 head and body. Treated steel cover. | By pull button | – | 1 1 | NC + NO slow break | LH side | XY2CJL15 (2) | 0.669 |
| | | | | 2 – | NC + NC slow break | LH side | XY2CJL17 (2) | 0.669 |
| | | | | 2 1 | 2 NC + 1 NO slow break | LH side | XY2CJL19 (2) (3) | 0.669 |



XY2CJS15

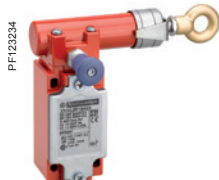

XY2CJR15



XY2CJL15

(1) See separate components on page 8.

(2) For ISO M20 threaded cable entry version, add H29 to the end of the reference selected.

Example: **XY2CJS15** becomes **XY2CJS15H29**.

(3) For 1/2" NPT threaded cable entry version, add H7 to the end of the reference selected.

Example: **XY2CJS19** becomes **XY2CJS19H7**.

Safety detection solutions

Emergency stop rope pull switches

Preventa XY2C



XY2CH13250

Latching emergency stops

Pg 13.5 and ISO M20 with integral tensioner. Cable and end spring to be ordered separately (1)

Without pilot light

| Cable length | Colours and materials | Reset | Supply voltage | Contact type | Cable anchor point | Reference | Weight kg | | |
|--------------|---|--|----------------|--------------|--------------------|--------------------|-----------------------|-----------------------|-------|
| ≤ 30 m | Zamak red RAL 3000 body. Stainless steel cover. | By booted pushbutton | – | 1 1 | NC + NO slow break | RH side or LH side | XY2CH13250 (3) | 0.865 | |
| | | By mushroom head pushbutton | – | 1 1 | | | XY2CH13350 (3) | 0.900 | |
| | | By key-operated pushbutton (key no. 421) (2) | – | 1 1 | | | XY2CH13450 (3) | 0.910 | |
| | By flush pushbutton | – | – | – | 2 – | NC + NC slow break | RH side or LH side | XY2CH13170 (3) | 0.865 |
| | | | | | | | | XY2CH13270 (3) | 0.865 |
| | | | | | | | | XY2CH13370 (3) | 0.865 |
| | | | | | | | | XY2CH13470 (3) | 0.910 |
| | | | | | | | | XY2CH13190 (3) | 0.865 |
| | | | | | | | | XY2CH13290 (3) | 0.865 |
| | By mushroom head pushbutton | – | – | – | 2 1 | | RH side or LH side | XY2CH13390 (3) | 0.865 |

With orange pilot light (direct supply)

| | | | | | | | | |
|--------|---|----------------------|----------|-----|------------------------|--------------------|-----------------------|-------|
| ≤ 30 m | Red RAL 3000 body. Stainless steel cover. | By booted pushbutton | 24 V ~/– | 1 1 | NC + NO slow break | RH side or LH side | XY2CH13253 | 0.900 |
| | | | | 2 – | NC + NC slow break | | XY2CH13273 | 0.900 |
| | | | | 2 1 | 2 NC + 1 NO slow break | | XY2CH13293 (3) | 0.950 |

Latching emergency stops

Pg 13.5 and ISO M20. Turnbuckle, cable and end spring to be ordered separately (1)

Without pilot light

| | | | | | | | | | | |
|--------|---|-----------------------------|---|-----|--------------------|---------|--------------------|---------|-------------------|-------|
| ≤ 70 m | Zamak red RAL 3000 body. Stainless steel cover. | By booted pushbutton | – | 1 1 | NC + NO slow break | RH side | XY2CE1A250 | 1.450 | | |
| | | | | 2 – | NC + NC slow break | LH side | XY2CE2A250 | 1.450 | | |
| | | By key switch (key no. 421) | | – | – | 1 1 | NC + NO slow break | RH side | XY2CE1A450 | 1.465 |
| | | | | | | | | LH side | XY2CE2A450 | 1.465 |
| | | | | | | | | RH side | XY2CE1A470 | 1.470 |
| | | | | | | | | LH side | XY2CE2A470 | 1.470 |

With yellow LED pilot light (direct supply)

| | | | | | | | | |
|--------|---|----------------------|-----------------|-----|--------------------|---------|-------------------|-------|
| ≤ 70 m | Zamak red RAL 3000 body. Stainless steel cover. | By booted pushbutton | 24 to 130 V ~/– | 2 2 | NC + NO slow break | RH side | XY2CE1A296 | 1.470 |
| | | | | | | LH side | XY2CE2A296 | 1.470 |
| | | 230 to 240 V ~ | | 2 2 | NC + NO slow break | RH side | XY2CE1A297 | 1.470 |
| | | | | | | LH side | XY2CE2A297 | 1.470 |

Other versions

XY2CE with reset by Ø 30 mm mushroom head pushbutton.

XY2CE with window for viewing the cable tension, for adjustment whilst the cover is closed. Please consult our Customer Care Centre.

(1) See separate components on page 8.

(2) Ø 30 spring return key-operated mushroom head pushbutton.

(3) For ISO M20 threaded cable entry version, add H29 to the end of the reference selected. Example: **XY2CH13250** becomes **XY2CH13250H29**.

Safety detection solutions

Emergency stop rope pull switches

Preventa XY2C

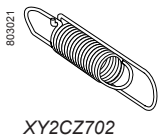
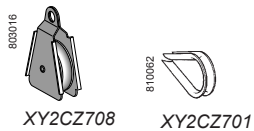
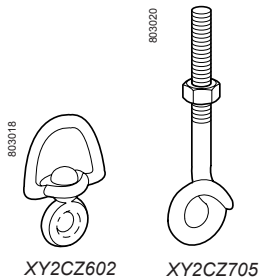
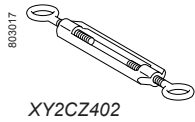
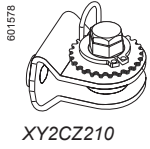

Separate components

| Description | For use with | Diameter mm | Length m | Reference | Weight kg |
|-----------------------------------|-----------------|-------------|----------|-----------|-----------|
| Galvanised cables with red sheath | XY2CJ and XY2CH | 3.2 | 10.5 | XY2CZ301 | 0.280 |
| | | | 15.5 | XY2CZ3015 | 0.410 |
| | | | 20.5 | XY2CZ3020 | 0.550 |
| | | | 25.5 | XY2CZ302 | 0.690 |
| | | | 30.5 | XY2CZ303 | 0.830 |
| | XY2CE | 5 | 15.5 | XY2CZ1015 | 0.850 |
| | | | 25.5 | XY2CZ102 | 1.400 |
| | | | 50.5 | XY2CZ105 | 2.750 |
| | | | 70.5 | XY2CZ107 | 3.870 |

| Description | Type | For use with | Sold in lots of | Unit reference | Weight kg | |
|----------------------|------|-------------------|-------------------|----------------|-----------|-------|
| Tensioner | – | XY2CJ | 1 | XY2CZ210 | 0.051 | |
| Turnbuckles | | M6 x 60 + locknut | All models (1) | 1 | XY2CZ402 | 0.060 |
| | | M8 x 70 + locknut | All models (1) | 1 | XY2CZ404 | 0.100 |
| Cable grips | | Single | Cable Ø 3 to 5 mm | 10 | XY2CZ503 | 0.007 |
| | | | | 10 | XY2CZ513 | 0.016 |
| | | Clamp | Cable Ø 3.2 mm | 10 | XY2CZ523 | 0.050 |
| | | | | 10 | XY2CZ524 | 0.080 |
| Cable supports | | All models | 10 | XY2CZ601 | 0.030 | |
| | | | 1 | XY2CZ602 | 0.130 | |
| | | | 1 | XY2CZ705 | 0.060 | |
| Pulley | | Cable Ø 5 mm max. | All models | 1 | XY2CZ708 | 0.056 |
| Cable end protectors | – | Cable Ø 3.2 mm | 10 | XY2CZ701 | 0.002 | |
| | | | 10 | XY2CZ704 | 0.010 | |
| End springs | – | XY2CJ and XY2CH | 1 | XY2CZ703 | 0.035 | |
| | | | XY2CE | 1 | XY2CZ702 | 0.080 |

(1) XY2CH13●●● and XY2CH14●●● emergency stop rope pull switches incorporate a cable tensioner as standard. Therefore, there is no need to order a turnbuckle.

DFE601301

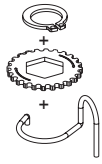

XY2CZ918

| Kits and mounting accessories | | | | | |
|---|--------------------|----------------|--------------|------------------|--------|
| Kit contents | For use with | Cable diameter | Cable length | Reference | Weight |
| | | mm | m | | kg |
| 1 spring + 1 notched washer + 1 circlip | XY2CH | – | – | XY2CZ918 | 0.010 |
| 1 galvanised cable + 1 cable grip XY2CZ523 + 1 end spring XY2CZ703 | XY2CJ and XY2CH | 3.2 | 10.5 | XY2CZ9310 | 0.444 |
| | | | 15.5 | XY2CZ9315 | 0.581 |
| | | | 20.5 | XY2CZ9320 | 0.635 |
| | | | 30.5 | XY2CZ9330 | 1.055 |
| 1 galvanised cable + 4 cable grips XY2CZ523 + 1 tensioner XY2CZ210 + 1 cable support XY2CZ601 + 1 cable end protector XY2CZ701 + 1 end spring XY2CZ703 | XY2CJ | 3.2 | 30.5 | XY2CZ9425 | 2.045 |
| 1 galvanised cable + 4 cable grips XY2CZ524 + 1 turnbuckle XY2CZ404 + 1 cable support XY2CZ601 + 3 cable end protectors XY2CZ704 + 1 end spring XY2CZ702 | XY2CE | 5 | 25.5 | XY2CZ9525 | 1.853 |
| | | | 50.5 | XY2CZ9550 | 3.240 |
| | | | 70.5 | XY2CZ9570 | 4.426 |

Safety detection solutions

Emergency stop rope pull switches

Preventa XY2C

Replacement parts

| Description | For use with | Type | Reference | Weight kg |
|--|--|-------------------------------|--------------------|-----------|
| Reset pushbutton (blue), spring return | XY2CH and XY2CE | Flush with "R" marked on push | ZB5AA639 | 0.018 |
| | | Booted | ZB5AP6S | 0.019 |
| | | Mushroom head, Ø 30 | ZB5AC64 | 0.027 |
| Key switch | XY2CH and XY2CE | With key no. 421 | ZB5AG612R26 | 0.064 |
| | | With key no. 455 | ZB5AG6R26 | 0.064 |
| Key for reset button | XY2CH and XY2CE | No. 421 | Q99900911 | 0.006 |
| | | No. 455 | Q99900901 | 0.006 |
| Pilot light head assembly | XY2CE | Red | XY2CZ800 | 0.015 |
| | | Orange | XY2CZ801 | 0.015 |
| Set of 5 cover gaskets | XY2CE | – | XY2CZ805 | 0.122 |
| Fixing nut, plastic, grey | XY2CH and XY2CE | – | ZB5AZ901 | 0.002 |
| Fixing nut tightening key, plastic, grey | XY2CH and XY2CE For fixing nut ZB5AZ901 | – | ZB5AZ905 | 0.016 |

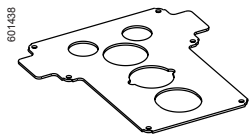

XY2CZ805

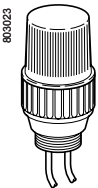

XY2CZ800

| Description | For use with | Voltage | Sold in lots of | Unit reference | Weight kg |
|---|---|----------------|-----------------|----------------------|-----------|
| Pilot lights With bulb DL1AA●●● included | XY2CH Colour: orange | 24 V ~/- | 1 | XY2CZ0024 (1) | 0.035 |
| | | 130 V ~/- | 1 | XY2CZ0130 (1) | 0.035 |
| | | 230 V ~/- | 1 | XY2CZ0230 (1) | 0.035 |
| Supply on LED | XY2CE Colour: red | 24 V ~/- | 5 | ZALVB4 | 0.015 |
| | | 48 to 120 V ~ | 5 | ZALVG4 | 0.015 |
| | | 230 to 240 V ~ | 5 | ZALVM4 | 0.015 |
| | XY2CE Colour: yellow | 24 V ~/- | 5 | ZALVB5 | 0.015 |
| | | 48 to 120 V ~ | 5 | ZALVG5 | 0.015 |
| | | 230 to 240 V ~ | 5 | ZALVM5 | 0.015 |
| Incandescent bulbs, screw base fitting | XY2CH | 24 V - 6 W | 10 | DL1AA024 | 0.004 |
| | | 130 V - 6 W | 10 | DL1AA127 | 0.004 |
| | | 230 V - 6 W | 10 | DL1AA220 | 0.004 |
| Set of 5 collars | For mounting bulbs DL1AA127 and DL1AA220 in pilot lights XY2CZ●●● | – | 5 | XY2CZ908 | 0.018 |

(1) Only for use as replacement parts on switches pre-fitted with pilot lights. CCC and UL-CSA approvals no longer apply if an XY2CZ●●● pilot light is mounted on XY2 CH emergency stops.

Emergency stop rope pull switches

XY2CJ

XY2CJS●●

XY2CJR●● and XY2CJL●● (same dimensions with anchor point on RH side or LH side)

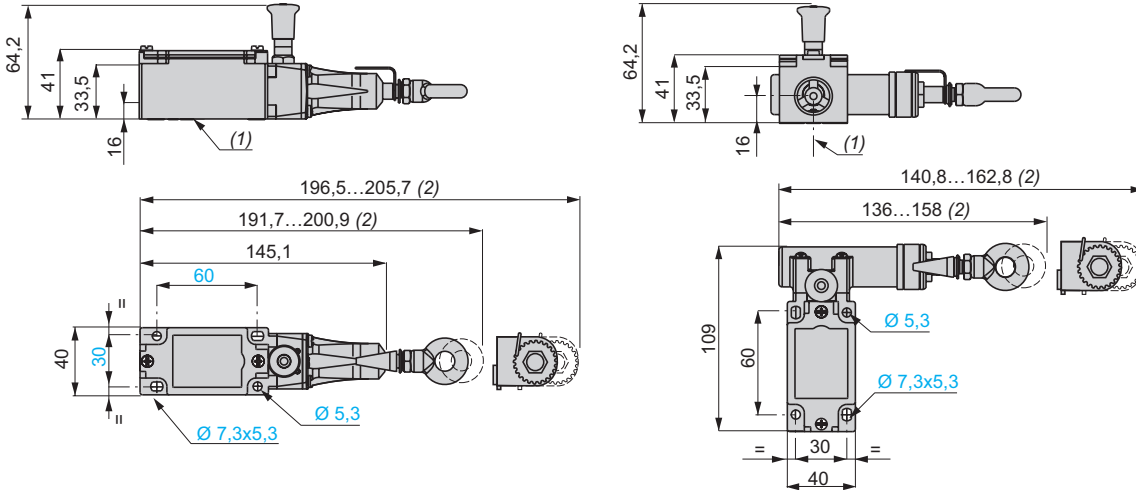

XY2CH

Without pilot light

With pilot light

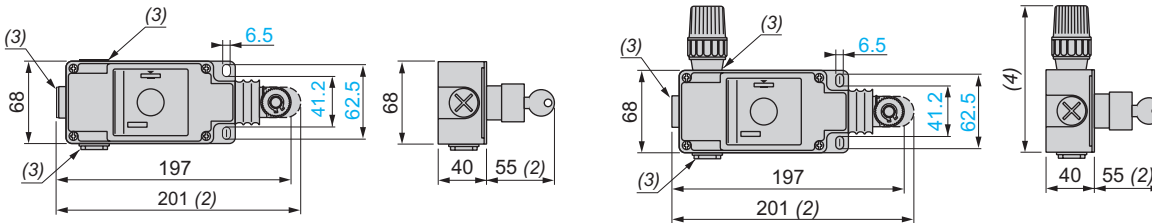

XY2CE

XY2CE1A●●● and XY2CE2A●●● (same dimensions with anchor point on RH side or LH side)

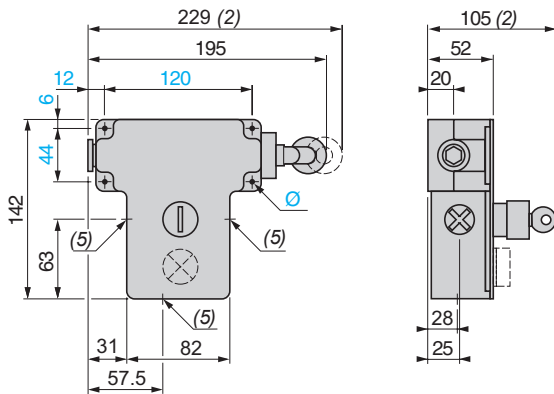

Accessories

XY2CZ705

XY2CZ708



- (1) Tapped entries for no. 13 cable gland (Pg 13.5). For ISO M20, the reference becomes XY2CJ●●●H29. For 1/2" NPT, the reference becomes XY2CJ●●●H7.
 - (2) Maximum extension.
 - (3) Tapped entries for no. 13 cable gland (Pg 13.5). For ISO M20, the reference becomes XY2CH●●●H29.
 - (4) 121 mm: 24 V and 48 V versions. 131 mm: 130 V and 230 V versions.
 - (5) 3 plain holes for no. 13 (Pg 13.5) or ISO M20 cable gland.
- Ø: 4 elongated holes Ø 6 mm.

| D | | | |
|------------|----|-------------|----|
| DL1AA024 | 10 | XY2CZ302 | 8 |
| DL1AA127 | 10 | XY2CZ303 | 8 |
| DL1AA220 | 10 | XY2CZ402 | 8 |
| | | XY2CZ404 | 8 |
| | | XY2CZ503 | 8 |
| Q | | | |
| Q99900901 | 10 | XY2CZ513 | 8 |
| Q99900911 | 10 | XY2CZ523 | 8 |
| | | XY2CZ524 | 8 |
| | | XY2CZ601 | 8 |
| | | XY2CZ602 | 8 |
| X | | | |
| XY2CE1A250 | 7 | XY2CZ701 | 8 |
| XY2CE1A270 | 7 | XY2CZ702 | 8 |
| XY2CE1A296 | 7 | XY2CZ703 | 8 |
| XY2CE1A297 | 7 | XY2CZ704 | 8 |
| XY2CE1A450 | 7 | XY2CZ705 | 8 |
| XY2CE1A470 | 7 | XY2CZ708 | 8 |
| XY2CE2A250 | 7 | XY2CZ800 | 10 |
| XY2CE2A270 | 7 | XY2CZ801 | 10 |
| XY2CE2A296 | 7 | XY2CZ805 | 10 |
| XY2CE2A297 | 7 | XY2CZ908 | 10 |
| XY2CE2A450 | 7 | XY2CZ918 | 9 |
| XY2CE2A470 | 7 | XY2CZ1015 | 8 |
| XY2CH13170 | 7 | XY2CZ3015 | 8 |
| XY2CH13190 | 7 | XY2CZ3020 | 8 |
| XY2CH13250 | 7 | XY2CZ9310 | 9 |
| XY2CH13253 | 7 | XY2CZ9315 | 9 |
| XY2CH13270 | 7 | XY2CZ9320 | 9 |
| XY2CH13273 | 7 | XY2CZ9330 | 9 |
| XY2CH13290 | 7 | XY2CZ9425 | 9 |
| XY2CH13293 | 7 | XY2CZ9525 | 9 |
| XY2CH13350 | 7 | XY2CZ9550 | 9 |
| XY2CH13370 | 7 | XY2CZ9570 | 9 |
| XY2CH13390 | 7 | | |
| XY2CH13450 | 7 | Z | |
| XY2CH13470 | 7 | ZALVB4 | 10 |
| XY2CJL15 | 6 | ZALVB5 | 10 |
| XY2CJL17 | 6 | ZALVG4 | 10 |
| XY2CJL19 | 6 | ZALVG5 | 10 |
| XY2CJR15 | 6 | ZALVM4 | 10 |
| XY2CJR17 | 6 | ZALVM5 | 10 |
| XY2CJR19 | 6 | ZB5AA639 | 10 |
| XY2CJS15 | 6 | ZB5AC64 | 10 |
| XY2CJS17 | 6 | ZB5AG6R26 | 10 |
| XY2CJS19 | 6 | ZB5AG612R26 | 10 |
| XY2CZ0024 | 10 | ZB5AP6S | 10 |
| XY2CZ102 | 8 | ZB5AZ901 | 10 |
| XY2CZ105 | 8 | ZB5AZ905 | 10 |
| XY2CZ107 | 8 | | |
| XY2CZ0130 | 10 | | |
| XY2CZ210 | 8 | | |
| XY2CZ0230 | 10 | | |
| XY2CZ301 | 8 | | |

Schneider Electric Industries SAS

Head Office
35, rue Joseph Monier
F-92500 Rueil-Malmaison
France

www.tesensors.com

The information provided in this documentation contains general descriptions and/or technical characteristics of the performance of the products contained herein. This documentation is not intended as a substitute for and is not to be used for determining suitability or reliability of these products for specific user applications. It is the duty of any such user or integrator to perform the appropriate and complete risk analysis, evaluation and testing of the products with respect to the relevant specific application or use thereof. Neither Schneider Electric nor any of its affiliates or subsidiaries shall be responsible or liable for misuse of the information contained herein.

Design: Schneider Electric
Photos: Schneider Electric