

linear/swivel clamp CLR-20-20-R-P-A

Part number: 535441

FESTO

Clamping system with linear and swivel motion, 90° to the right,
standard port pattern per ISO 21287

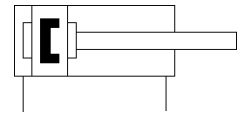
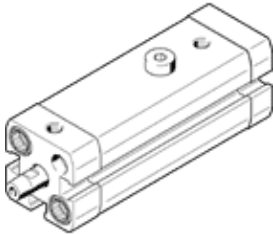

Data sheet

Feature	Value
Total stroke	32 mm
Piston diameter	20 mm
Piston rod thread	M6
Swivel angle	90 deg +/- 3 deg
Clamping stroke	20 mm
Cushioning	P: Flexible cushioning rings/plates at both ends
Assembly position	Any
Design structure	Piston Piston rod Cylinder barrel
Position detection	For proximity sensor
Swivel direction	Right
Operating pressure	2 ... 10 bar
Mode of operation	double-acting
Operating medium	Compressed air in accordance with ISO8573-1:2010 [7:4:4]
Note on operating and pilot medium	Lubricated operation possible (subsequently required for further operation)
Corrosion resistance classification CRC	2 - Moderate corrosion stress
Ambient temperature	-10 ... 80 °C
Effective clamping force at 2 bar	35 N
Effective clamping force at 4 bar	73 N
Effective clamping force at 6 bar	109 N
Max. tightening torque, tensioning finger screw	12 Nm
Theoretical clamping force at 6 bar	121 N
Product weight	385 g
Mounting type	Optional with through hole with internal (female) thread with accessories
Pneumatic connection	M5
Material of flange screw	Steel Galvanised
Material cover	Wrought Aluminium alloy coated
Material seals	NBR TPE-U(PU)
Material housing	Wrought Aluminium alloy Smooth anodised
Material piston rod	High alloy steel, non-corrosive
Material cylinder barrel	Wrought Aluminium alloy Smooth anodised