



Power Bridge Rectifiers

SKB 50

Features

- Isolated metal case with screw terminals
- Blocking voltage to 1600 V
- High surge current
- Easy chassis mounting

Typical Applications

- Single phase rectifiers for power supplies
- Input rectifiers for variable frequency drives
- Rectifiers for DC motor field supplies
- Battery charger rectifiers
- Recommended snubber network:
RC: 0.1 μ F, 50 Ω ($P_R = 1$ W)

1) Freely suspended or mounted on an insulator

2) Mounted on a painted metal sheet of min. 250 x 250 x 1 mm

V_{RSM}, V_{RRM} V	V_{VRMS} V	$I_D = 50$ A ($T_c = 64$ °C) Types	C_{max} μ F	R_{min} Ω
200	60	SKB 50/02 A3		0,1
400	125	SKB 50/04 A3		0,3
800	250	SKB 50/08 A3		0,4
1200	380	SKB 50/12 A3		0,6
1400	440	SKB 50/14 A3		0,7
1600	500	SKB 50/16 A3		0,8

Symbol	Conditions	Values	Units	
I_D	$T_a = 45$ °C, isolated ¹⁾	10	A	
	$T_a = 45$ °C, chassis ²⁾	20	A	
I_{DCL}	$T_a = 45$ °C, isolated ¹⁾	8	A	
	$T_a = 45$ °C, chassis ²⁾	16	A	
	$T_a = 35$ °C, P1A/120 F	40	A	
I_{FSM}	$T_{vj} = 25$ °C, 10 ms	750	A	
	$T_{vj} = 150$ °C, 10 ms	600	A	
i^2t	$T_{vj} = 25$ °C, 8,3 ... 10 ms	2800	A ² s	
	$T_{vj} = 150$ °C, 8,3 ... 10 ms	1800	A ² s	
V_F	$T_{vj} = 25$ °C, $I_F = 150$ A	max. 1,6	V	
$V_{(TO)}$	$T_{vj} = 150$ °C	max. 0,85	V	
r_T	$T_{vj} = 150$ °C	max. 8	m Ω	
I_{RD}	$T_{vj} = 25$ °C, $V_{RD} = V_{RRM}$	1000	μ A	
	$T_{vj} =$ °C, $V_{RD} = V_{RRM} \geq V$		μ A	
I_{RD}	$T_{vj} = 150$ °C, $V_{RD} = V_{RRM}$	10	mA	
	$T_{vj} =$ °C, $V_{RD} = V_{RRM} \geq V$		mA	
t_{rr}	$T_{vj} = 25$ °C	10	μ s	
f_G		2000	Hz	
$R_{th(j-a)}$	isolated ¹⁾	5,7	K/W	
	chassis ²⁾	2,5	K/W	
	total	0,65	K/W	
	$R_{th(j-c)}$	total	0,06	K/W
	$R_{th(c-s)}$	total		K/W
T_{vj}		- 40 ... + 150	°C	
T_{stg}		- 55 ... + 150	°C	
V_{isol}	a.c. 50 ... 60 Hz; r.m.s., 1 s / 1 min.	3000/2500	V~	
M_s	to heatsink	5 \pm 15 %	Nm	
M_t	to terminals	3 \pm 15 %	Nm	
a			m/s ²	
w		250	g	
F_u		50	A	
Case		G 14		

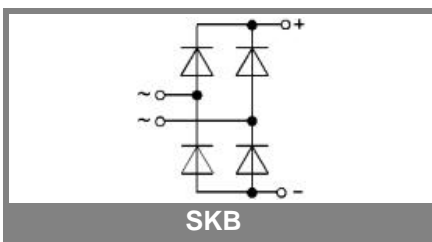

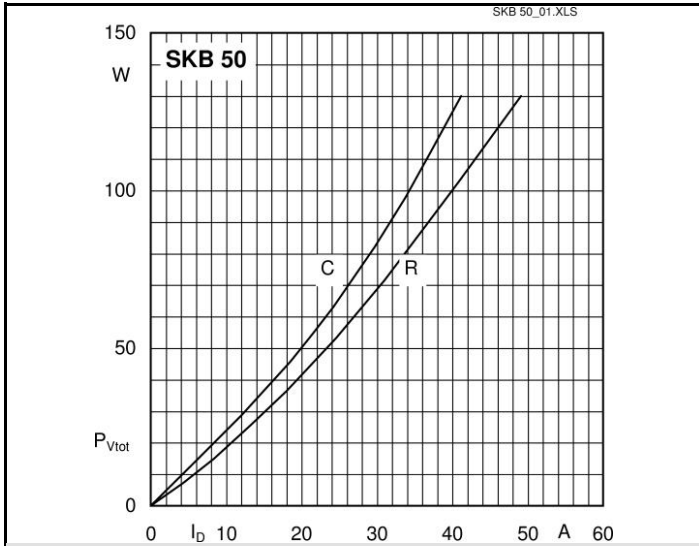

Fig. 3L Power dissipation vs. output current

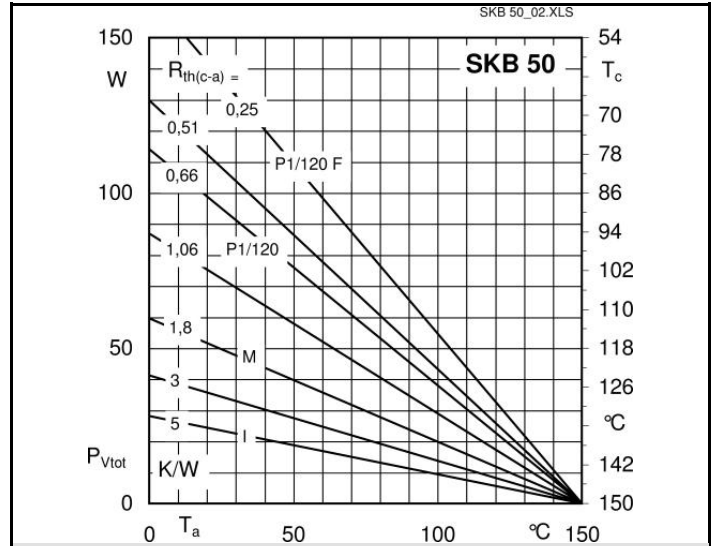

Fig. 3R Power dissipation vs. case temperature

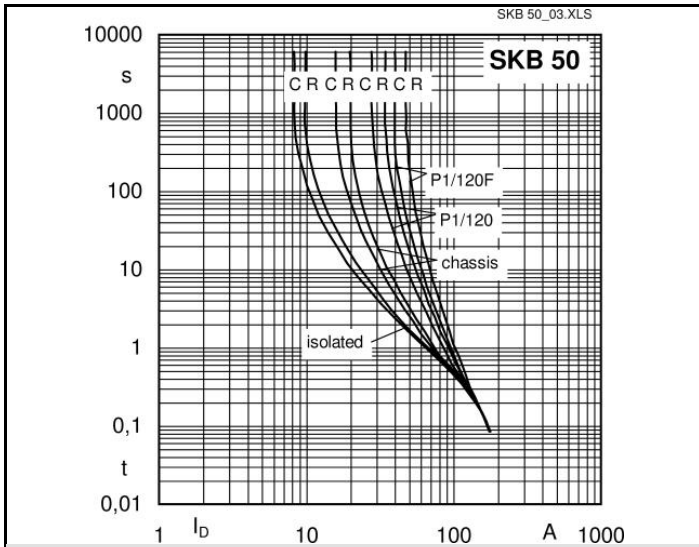

Fig. 6 Rated overload characteristics vs. time

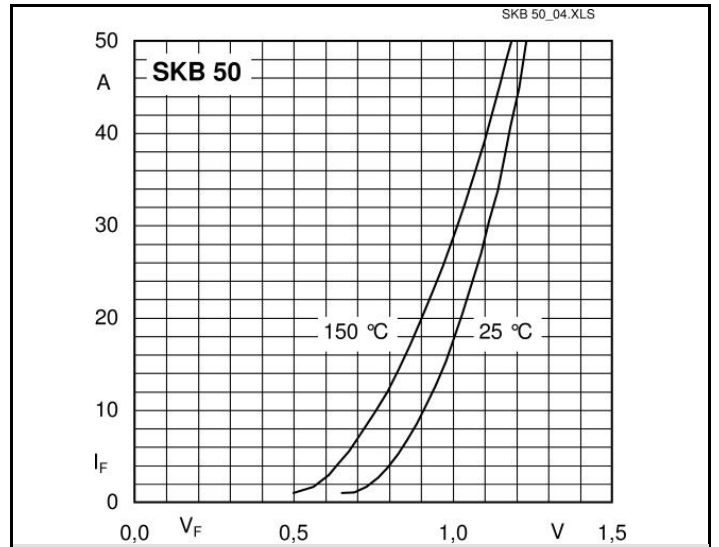
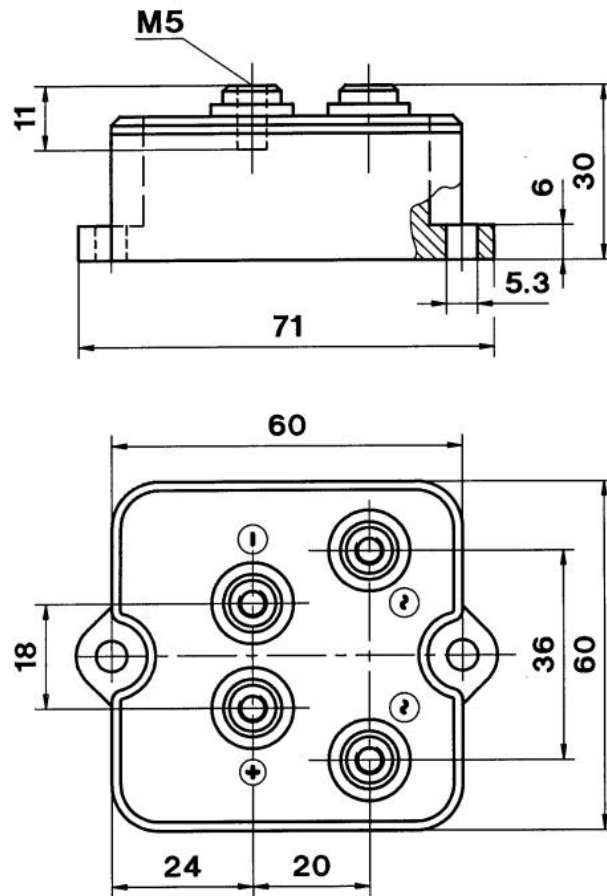

Fig. 9 Forward characteristics of a diode arm



Case G 14

This technical information specifies semiconductor devices but promises no characteristics. No warranty or guarantee expressed or implied is made regarding delivery, performance or suitability.

Find price and stock options from leading distributors for SKB50/04A3 on Findchips.com:

<https://findchips.com/search/SKB50%2F04A3>

Find CAD models and details for this part:

<https://findchips.com/detail/skb50%2F04a3/SEMIKRON>